

PLEASE CHECK WWW.MOLEX.COM FOR LATEST PART INFORMATION

Part Number: [0901600150](#)
Status: **Active**
Overview: [cgrid_iii](#)
Description: 2.54mm (.100") Pitch C-Grid III™ Crimp Housing - Dual Row, 50 Circuits

Documents:

[3D Model](#) [RoHS Certificate of Compliance \(PDF\)](#)
[Drawing \(PDF\)](#)

General

Product Family	Crimp Housings
Series	90160
Overview	cgrid_iii
Product Name	C-Grid III™

Physical

Breakaway	No
Circuits (maximum)	50
Color - Resin	Black
Gender	Female
Glow-Wire Compliant	No
Material - Resin	PPO
Number of Rows	2
Packaging Type	Bag
Panel Mount	No
Pitch - Mating Interface (in)	0.100 In
Pitch - Mating Interface (mm)	2.54 mm
Temperature Range - Operating	-55°C to +105°C

Material Info

Reference - Drawing Numbers

Sales Drawing	SD-90160
---------------	----------

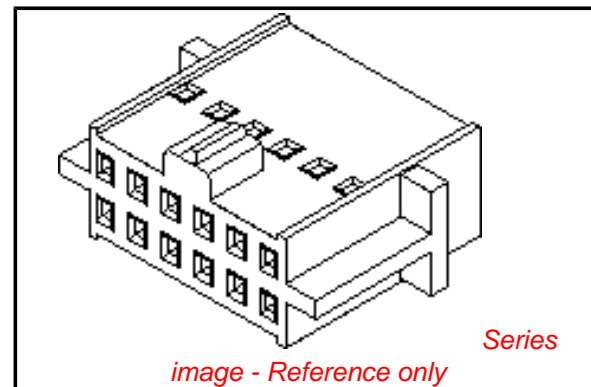

EU RoHS

**ELV and RoHS
Compliant**
REACH SVHC
 Not Reviewed
**Halogen-Free
Status**
 Not Reviewed

China RoHS



**Need more information on product
environmental compliance?**

Email productcompliance@molex.com
 For a multiple part number RoHS Certificate of Compliance, [click here](#)

Please visit the [Contact Us](#) section for any non-product compliance questions.

Search Parts in this Series

90160Series

Mates With

90663 , 90635

Use With

90119

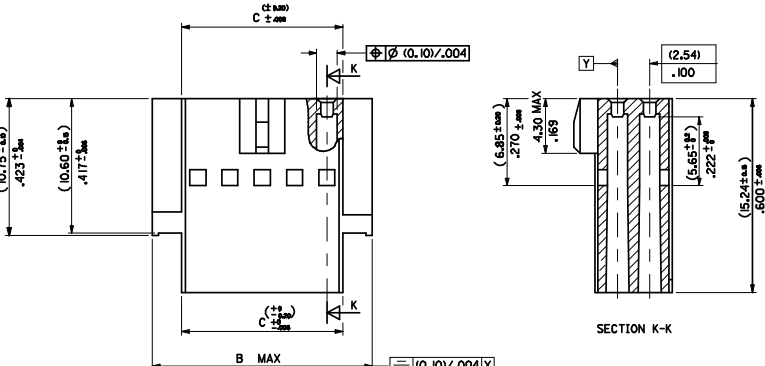
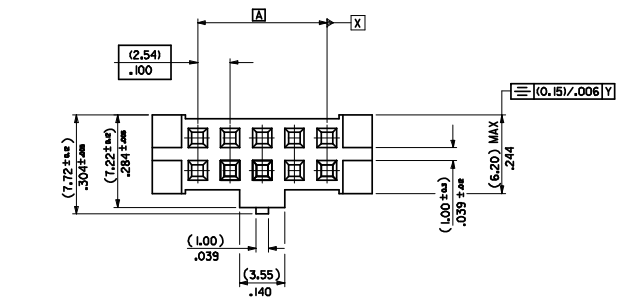

No. OF CKTS	PART NUMBER	DIM A	DIM B	DIM C
2				
4				
6				
8	90160-0108	(7.62) / .300	(14.93) / .588	(10.16) / .400
10		(10.16) / .400	(17.47) / .688	(12.70) / .500
12		(12.70) / .500	(20.01) / .788	(15.24) / .600
14		(15.24) / .600	(22.55) / .888	(17.78) / .700
16		(17.78) / .700	(25.09) / .988	(20.32) / .800
18		(20.32) / .800	(27.63) / 1.088	(22.86) / .900
20		(22.86) / .900	(30.17) / 1.188	(25.40) / 1.000
22				
24				
26		(30.48) / 1.200	(37.79) / 1.488	(33.02) / 1.300
28				
30				
32				
34		(40.64) / 1.600	(47.95) / 1.888	(43.18) / 1.700
36				
38				
40		(48.26) / 1.900	(55.57) / 2.188	(50.80) / 2.000
42				
44				
46				
48				
50		(60.96) / 2.400	(68.27) / 2.688	(63.50) / 2.500
52				
54				
56				
58				
60		(73.66) / 2.900	(80.97) / 3.188	(76.20) / 3.000
62				
64	90160-0164	(78.74) / 3.100	(86.05) / 3.388	(81.28) / 3.200
66				
68				

NOTES
 1. MATERIAL:-
 - POLYPHENYLENE OXIDE
 - UL 94 V-1 COLOUR BLACK
 90160 - 0 1 X X
 X INDICATES No OF CIRCUITS
 2. PRODUCT SPECIFICATION: PS-99020-0001

ADDED NOTE 2 EC NO: E2008-0466 DRAWN BY: TDRANKI LERMAN 2008/03/12 CHECKED BY: CHIKO BHAGUIRE 2008/03/18 APPROVED BY: APPR: BHAGUIRE 2008/03/18	QUALITY SYMBOLS	GENERAL TOLERANCES (UNLESS SPECIFIED)	DIMENSION STYLE	SCALE	DESIGN UNITS	THIRD ANGLE PROJECTION
	▽=0	4 PLACES ± --- ±	MM ONLY	5:1	METRIC	☉
	▽=0.004	3 PLACES ± --- ±.004	DRAWN BY DATE	TITLE		
	▽=0.10	2 PLACES ± 0.10 ± ---	CHECKED BY DATE	C GRID III DUAL ROW CRIMP CONNECTOR HOUSING		
▽=0	1 PLACE ± --- ± ---	APPROVED BY DATE	MOLEX INCORPORATED			
	ANGULAR ± 2 °	MATERIAL NO.	DOCUMENT NO.		SHEET NO.	
	DRAFT WHERE APPLICABLE MUST REMAIN WITHIN DIMENSIONS	SEE CHART	SD-90160		1 OF 00	
		SIZE	THIS DRAWING CONTAINS INFORMATION THAT IS PROPRIETARY TO MOLEX INCORPORATED AND SHOULD NOT BE USED WITHOUT WRITTEN PERMISSION			

SHT. 1 OF		MRI-SD-90160			
MODIFICATION RECORD INDEX					
ERD	ECO	ISS. DATE	INIT.	SHTS. AFFECTED	DESCRIPTION OF MOD.
599	I	22.6.83	MRS		X - RELEASE
651		28.7.83	MRS		REVISION
686	A	6.9.83	MD		TOOL RELEASE
	877	B 3.4.87	KS		REVISION
	977	C 21.10.87	KS		DRAWN ON CAD
	E2012	D 11.02.92	TC		REMOVAL OF WINDOWS
ECN	ISS. DATE	INIT.	SHTS. AFFECTED	DESCRIPTION OF MOD.	
E30146	E	93.02.22	BGB	I	OMMITTED RETOOL MODS

MOLEX EUROPE	REVISE ONLY ON CAD SYSTEM
THIS DRAWING CONTAINS INFORMATION THAT IS PROPRIETARY TO MOLEX INC. & SHOULD NOT BE USED WITHOUT WRITTEN PERMISSION	CADD FILENAME: SD90160X1.DGN
TITLE	E

LEVEL CHART

1	17	33	49
2	18	34	50
3	19	35	51 LEVEL INDEX
4	20 DATASHEET	36	52 RESERVED
5	21	37	53 RESERVED
6	22	38	54 RESERVED
7	23	39	55 DIMENSIONS
8	24	40	56 TABLES/CHARTS
9	25	41	57 REVISION TEXT & MR
10	26	42	58 NOTES/TEXT
11 GEOMETRY	27	43	59
12	28	44	60 RESERVED
13	29	45	61
14	30	46	62
15 XHATCH	31	47	63
16	32	48	